

## FLEXILITE™ SDI FLA SERIES

Flexible Aluminium (Fixed Wiring), LSHF  
Single Core SDI Cable 0.6/1kV 110°C



### APPLICATIONS:

**Power distribution:** Suitable for use in main and sub-main circuits on cable tray, ladder racks and buried in conduit or ducting.

**High current installations:** Perfect for high current installations where a lightweight and cost-effective solution is critical for reducing install costs.

**Industrial Power Supply:** Used in factories, warehouses, and heavy-duty machinery to supply power efficiently over large distances.

**Greenstar applications:** PVC-free, Low Smoke Halogen Free construction suitable for sustainable building standards.

| FEATURES   | BENEFITS  |
|--|---|
| <b>Super lightweight construction:</b> Aluminium conductors, significantly lighter than copper cables with up to 50% weight reduction. | Easier handling and faster installation, especially in hard-to-access environments.                                     |
| <b>EASY RUN™ finely stranded conductors</b> provide flexibility and improved bending radius compared with traditional class 2 cables   | Making it easier and faster to install, especially in confined spaces.  |
| <b>EASY GLIDE™ low-friction sheath</b>   | Making it easier to pull through conduit and ensuring a much smoother installation.                                     |
| <b>FLEXI CHILL™</b> remains flexible in cold temperatures  | Making it easy to install in cold conditions.   |
| <b>Low Smoke Halogen Free sheath (LSHF)</b>  | Minimises toxic fumes and smoke in the event of a fire.   |
| <b>Flame retardant sheath made to IEC 60332-3-22</b>   | Reduces fire spread in high-density, bunched cable routes through critical areas, ensuring minimised flame propagation. |
| <b>UV stabilised black sheath</b>  | Provides prolonged UV resistance to sunlight degradation.   |

### CONSTRUCTION:

**Conductor:** Finely stranded EC1350 aluminium

**Insulation:** X-HF-110

**Sheath:** SE-LSHF-EG

### CHARACTERISTICS:

**Operating Temperature Range:** Fixed -25°C to 110°C

**Maximum Conductor Temperature:** 110°C

**Rated Voltage:** U<sub>0</sub>/U 0.6/1kV.

**Max AC Operating Voltage:** U<sub>0</sub> 0.7kV.

**Minimum bending radius during installation:** 150mm<sup>2</sup> and below = 5.5 x cable diameter. 185mm<sup>2</sup> and above = 9 x cable diameter.

**Minimum bending radius after installation:** 150mm<sup>2</sup> and below = 4 x cable diameter. 185mm<sup>2</sup> and above = 6 x cable diameter.

**Sheath Colour:** Black (other colours available on request)

**Insulation Colour:** White

**Relevant Standards** IEC 60332-1, IEC 60332-1-2, IEC 60332-3-22, IEC 61034.2, IEC 60754.1, AS/NZS 5000.1, AS/NZS 1125, AS/NZS 3808,

**RoHS** Compliant.

See over for full product table ▶

# FLEXIBLE SINGLE CORE CABLES

## FLEXILITE™ SDI FLA SERIES continued



| Code      | No. of cores x Size | Approx. overall diameter | Listed pulling force | Approx. weight | D. C. resistance of conductor 20°C | Nominal amps un-enclosed @ 30°C fixed application  |
|-----------|---------------------|--------------------------|----------------------|----------------|------------------------------------|--|
|           | (mm <sup>2</sup> )  | (mm)                     | (kN)                 | (Kg/Km)        | (Ω/Km)                             | Touching  |
| FLA070/BK | 1 x 70.0            | 16.9                     | 2.7                  | 347            | 0.443                              | 220  |
| FLA095/BK | 1 x 95.0            | 18.7                     | 3.7                  | 439            | 0.32                               | 274  |
| FLA120/BK | 1 x 120.0           | 20.4                     | 4.6                  | 528            | 0.253                              | 320  |
| FLA150/BK | 1 x 150.0           | 23.1                     | 5.9                  | 656            | 0.206                              | 368  |
| FLA185/BK | 1 x 185.0           | 25.6                     | 7.2                  | 809            | 0.164                              | 429  |
| FLA240/BK | 1 x 240.0           | 28.7                     | 9.4                  | 1022           | 0.125                              | 516  |
| FLA300/BK | 1 x 300.0           | 31.8                     | 11.7                 | 1242           | 0.1                                | 597  |
| FLA400/BK | 1 x 400.0           | 35.8                     | 15.6                 | 1602           | 0.0778                             | 705  |
| FLA500/BK | 1 x 500.0           | 39.8                     | 19.5                 | 1982           | 0.0605                             | 825  |
| FLA630/BK | 1 x 630.0           | 44.8                     | 24.6                 | 2542           | 0.0469                             | 969  |

### IMPORTANT CUSTOMER NOTICE: CABLE END SEALING

ALL FLA SERIES CABLES ARE SUPPLIED WITH FACTORY-APPLIED PROTECTIVE END CAPS.

**CRITICAL REQUIREMENT:** To maintain the cable's integrity and conductor properties, the cable ends must be kept sealed at all times, including during storage, installation, and any temporary layover periods. Any moisture ingress due to failure to maintain a continuous, effective seal will void the product warranty.

## BI-METAL LUGS FOR FIRSTFLEX FLA SERIES ALUMINIUM CABLES

The CABAC range of bi-metallic compression lugs are designed specifically for terminating fine stranded Firstflex FLA series flexible aluminium cables. The aluminium barrel is sized to suit the larger overall diameters of flexible conductors, ensuring full strand containment and reliable crimp performance.

The lug comprises a high-conductivity aluminium barrel friction welded to an electrolytic copper palm, providing a strong, corrosion-resistant transition joint. The barrel is pre-filled with oxide-inhibiting compound to minimise oxidation and maintain low contact resistance.

Suitable for hexagonal compression crimping using the specified A/F dies.

Where multiple crimps are required, crimp from the palm end toward the cable entry.

Conforms to: AS/NZS 4325.1 and IEC 61238-1-1

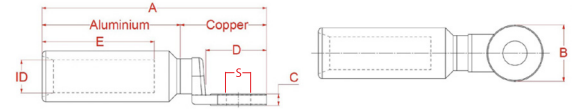

| FF Code   | Bi Metal Flexible Aluminium Lugs          | NOMINAL CONDUCTOR CSA mm <sup>2</sup> | ID (+0.2 -0.1) | A (±2) | B (±1) | C (±0.5) | D (±1.0) | E (±1.5) | S (±0.25) | A/F HEX | CRIMP DIE      | NO. OF CRIMPS |
|-----------|---|---------------------------------------|----------------|--------|--------|----------|----------|----------|-----------|---------|----------------|---------------|
| FBL70M8   | Bi Metal Flexi Ali Crimp Lug, 70mm M8     | 70                                    | 12             | 75     | 24     | 5        | 26.5     | 32       | 8.5       | 13.2    | HT-50/70AL     | 1             |
| FBL70M10  | Bi Metal Flexi Ali Crimp Lug, 70mm M10    | 70                                    | 12             | 75     | 24     | 5        | 26.5     | 32       | 10.5      | 13.2    | HT-50/70AL     | 1             |
| FBL70M12  | Bi Metal Flexi Ali Crimp Lug, 70mm M12    | 70                                    | 12             | 75     | 24     | 5        | 26.5     | 32       | 13        | 13.2    | HT-50/70AL     | 1             |
| FBL70B    | Bi Metal Flexi Ali Crimp Lug, 70mm Blank  | 70                                    | 12             | 75     | 24     | 5        | 26.5     | 32       | -         | 13.2    | HT-50/70AL     | 1             |
| FBL95M8   | Bi Metal Flexi Ali Crimp Lug, 95mm M8     | 95                                    | 14             | 115    | 24     | 5        | 26.5     | 60       | 8.5       | 17.3    | HT-95/120AL    | 2             |
| FBL95M10  | Bi Metal Flexi Ali Crimp Lug, 95mm M10    | 95                                    | 14             | 115    | 24     | 5        | 26.5     | 60       | 10.5      | 17.3    | HT-95/120AL    | 2             |
| FBL95M12  | Bi Metal Flexi Ali Crimp Lug, 95mm M12    | 95                                    | 14             | 115    | 24     | 5        | 26.5     | 60       | 13        | 17.3    | HT-95/120AL    | 2             |
| FBL95B    | Bi Metal Flexi Ali Crimp Lug, 95mm Blank  | 95                                    | 14             | 115    | 24     | 5        | 26.5     | 60       | -         | 17.3    | HT-95/120AL    | 2             |
| FBL120M8  | Bi Metal Flexi Ali Crimp Lug, 120mm M8    | 120                                   | 17.5           | 120    | 30     | 6        | 32.5     | 60       | 8.5       | 22      | HT-150/185AL   | 2             |
| FBL120M10 | Bi Metal Flexi Ali Crimp Lug, 120mm M10   | 120                                   | 17.5           | 120    | 30     | 6        | 32.5     | 60       | 10.5      | 22      | HT-150/185AL   | 2             |
| FBL120M12 | Bi Metal Flexi Ali Crimp Lug, 120mm M12   | 120                                   | 17.5           | 120    | 30     | 6        | 32.5     | 60       | 13        | 22      | HT-150/185AL   | 2             |
| FBL120B   | Bi Metal Flexi Ali Crimp Lug, 120mm Blank | 120                                   | 17.5           | 120    | 30     | 6        | 32.5     | 60       | -         | 22      | HT-150/185AL   | 2             |
| FBL150M8  | Bi Metal Flexi Ali Crimp Lug, 150mm M8    | 150                                   | 18.7           | 120    | 30     | 6        | 32.5     | 60       | 8.5       | 22      | HT-150/185AL   | 2             |
| FBL150M10 | Bi Metal Flexi Ali Crimp Lug, 150mm M10   | 150                                   | 18.7           | 120    | 30     | 6        | 32.5     | 60       | 10.5      | 22      | HT-150/185AL   | 2             |
| FBL150M12 | Bi Metal Flexi Ali Crimp Lug, 150mm M12   | 150                                   | 18.7           | 120    | 30     | 6        | 32.5     | 60       | 13        | 22      | HT-150/185AL   | 2             |
| FBL150B   | Bi Metal Flexi Ali Crimp Lug, 150mm Blank | 150                                   | 18.7           | 120    | 30     | 6        | 32.5     | 60       | -         | 22      | HT-150/185AL   | 2             |
| FBL185M10 | Bi Metal Flexi Ali Crimp Lug, 185mm M10   | 185                                   | 19.5           | 120    | 35     | 7        | 37       | 60       | 10.5      | 22      | HT-150/185AL   | 2             |
| FBL185M12 | Bi Metal Flexi Ali Crimp Lug, 185mm M12   | 185                                   | 19.5           | 120    | 35     | 7        | 37       | 60       | 13        | 22      | HT-150/185AL   | 2             |
| FBL185B   | Bi Metal Flexi Ali Crimp Lug, 185mm Blank | 185                                   | 19.5           | 120    | 35     | 7        | 37       | 60       | -         | 22      | HT-150/185AL   | 2             |
| FBL240M10 | Bi Metal Flexi Ali Crimp Lug, 240mm M10   | 240                                   | 24             | 135    | 35     | 7        | 37       | 60       | 10.5      | 28.4    | HT-240/300AL   | 2             |
| FBL240M12 | Bi Metal Flexi Ali Crimp Lug, 240mm M12   | 240                                   | 24             | 135    | 35     | 7        | 37       | 60       | 13        | 28.4    | HT-240/300AL   | 2             |
| FBL240B   | Bi Metal Flexi Ali Crimp Lug, 240mm Blank | 240                                   | 24             | 135    | 35     | 7        | 37       | 60       | -         | 28.4    | HT-240/300AL   | 2             |
| FBL300M10 | Bi Metal Flexi Ali Crimp Lug, 300mm M10   | 300                                   | 26.5           | 135    | 36     | 7.5      | 38       | 60       | 10.5      | 28.4    | HT-240/300AL   | 2             |
| FBL300M12 | Bi Metal Flexi Ali Crimp Lug, 300mm M12   | 300                                   | 26.5           | 135    | 36     | 7.5      | 38       | 60       | 13        | 28.4    | HT-240/300AL   | 2             |
| FBL300M16 | Bi Metal Flexi Ali Crimp Lug, 300mm M16   | 300                                   | 26.5           | 135    | 36     | 7.5      | 38       | 60       | 17        | 28.4    | HT-240/300AL   | 2             |
| FBL300B   | Bi Metal Flexi Ali Crimp Lug, 300mm Blank | 300                                   | 26.5           | 135    | 36     | 7.5      | 38       | 60       | -         | 28.4    | HT-240/300AL   | 2             |
| FBL400M10 | Bi Metal Flexi Ali Crimp Lug, 400mm M10   | 400                                   | 30.3           | 150    | 45     | 8        | 47       | 70       | 10.5      | 39      | ECW-H3D4/500AL | 2             |
| FBL400M12 | Bi Metal Flexi Ali Crimp Lug, 400mm M12   | 400                                   | 30.3           | 150    | 45     | 8        | 47       | 70       | 13        | 39      | ECW-H3D4/500AL | 2             |
| FBL400M16 | Bi Metal Flexi Ali Crimp Lug, 400mm M16   | 400                                   | 30.3           | 150    | 45     | 8        | 47       | 70       | 17        | 39      | ECW-H3D4/500AL | 2             |
| FBL400B   | Bi Metal Flexi Ali Crimp Lug, 400mm Blank | 400                                   | 30.3           | 150    | 45     | 8        | 47       | 70       | -         | 39      | ECW-H3D4/500AL | 2             |
| FBL500M10 | Bi Metal Flexi Ali Crimp Lug, 500mm M10   | 500                                   | 32.5           | 150    | 45     | 8        | 47       | 70       | 10.5      | 39      | ECW-H3D4/500AL | 2             |
| FBL500M12 | Bi Metal Flexi Ali Crimp Lug, 500mm M12   | 500                                   | 32.5           | 150    | 45     | 8        | 47       | 70       | 13        | 39      | ECW-H3D4/500AL | 2             |
| FBL500M16 | Bi Metal Flexi Ali Crimp Lug, 500mm M16   | 500                                   | 32.5           | 150    | 45     | 8        | 47       | 70       | 17        | 39      | ECW-H3D4/500AL | 2             |
| FBL500B   | Bi Metal Flexi Ali Crimp Lug, 500mm Blank | 500                                   | 32.5           | 150    | 45     | 8        | 47       | 70       | -         | 39      | ECW-H3D4/500AL | 2             |
| FBL630M12 | Bi Metal Flexi Ali Crimp Lug, 630mm M12   | 630                                   | 38             | 155    | 50     | 9        | 52       | 70       | 13        | 43.2    | RHU520-800     | 2             |
| FBL630M16 | Bi Metal Flexi Ali Crimp Lug, 630mm M16   | 630                                   | 38             | 155    | 50     | 9        | 52       | 70       | 17        | 43.2    | RHU520-800     | 2             |
| FBL630B   | Bi Metal Flexi Ali Crimp Lug, 630mm Blank | 630                                   | 38             | 155    | 50     | 9        | 52       | 70       | -         | 43.2    | RHU520-800     | 2             |

In support of CABAC policy of continuous product improvement CABAC reserve the right to change materials and specifications without notice. Drawings, where shown, may not be to scale. Dimensions are metric and size may be approximate. Where possible data sheets including MSDS are made available on CABAC website and apps. All products should be installed and used in accordance to manufacturer's instruction provided. Warning: products may be subject of registered designs and patents. Refer to CABAC website or apps for terms and conditions on warranty.

## BI-METAL CIRCUIT BREAKER LUGS FOR FIRSTFLEX FLA SERIES ALUMINIUM CABLES

Suitable for Firstflex FLA aluminium conductor cable and copper circuit breaker terminals  
 The CABAC range of circuit breaker bi-metallic compression lugs are designed specifically for terminating fine stranded Firstflex FLA flexible aluminium cables. The aluminium barrel is sized to suit the larger overall diameters of flexible conductors, ensuring full strand containment and reliable crimp performance.

The lug comprises a high-conductivity aluminium barrel friction welded to an electrolytic copper palm, providing a strong, corrosion-resistant transition joint. The barrel is pre-filled with oxide-inhibiting compound to minimise oxidation and maintain low contact resistance.

Suitable for hexagonal compression crimping using the specified A/F dies.

Where multiple crimps are required, crimp from the palm end toward the cable entry.  
 Conforms to: AS/NZS 4325.1 and IEC 61238-1-1

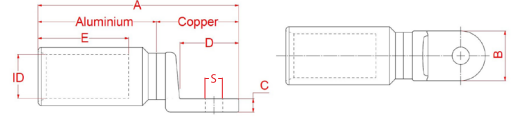

| Firstflex Code | Circuit breaker Bi Metal Lugs                         | NOMINAL CONDUCTOR CSA mm <sup>2</sup> | ID (+0.2 -0.1) | A (±2) | B (±1) | C (±0.5) | D (±1.0) | E (±1.5) | S (±0.25) | A/F HEX | CRIMP DIE      | NO. OF CRIMPS |
|----------------|---|---------------------------------------|----------------|--------|--------|----------|----------|----------|-----------|---------|----------------|---------------|
| FBL70CBM8      | Bi Metal Flexi Ali Narrow palm Crimp lug, 70mm M8     | 70                                    | 12             | 68     | 20     | 4        | 18       | 32       | 8.5       | 13.2    | HT-70AL        | 1             |
| FBL70CBM10     | Bi Metal Flexi Ali Narrow palm Crimp lug, 70mm M10    | 70                                    | 12             | 68     | 20     | 4        | 18       | 32       | 10.5      | 13.2    | HT-70AL        | 1             |
| FBL70CBB       | Bi Metal Flexi Ali Narrow palm Crimp lug, 70mm Blank  | 70                                    |                | 68     | 20     | 4        | 18       | 32       |           | 13.2    | HT-70AL        | 1             |
| FBL95CBM8      | Bi Metal Flexi Ali Narrow palm Crimp lug, 95mm M8     | 95                                    | 14             | 105    | 20     | 5        | 23       | 60       | 8.5       | 17.3    | HT-95/120AL    | 2             |
| FBL95CBM10     | Bi Metal Flexi Ali Narrow palm Crimp lug, 95mm M10    | 95                                    | 14             | 105    | 20     | 5        | 23       | 60       | 10.5      | 17.3    | HT-95/120AL    | 2             |
| FBL95CBM12     | Bi Metal Flexi Ali Narrow palm Crimp lug, 95mm M12    | 95                                    | 14             | 105    | 20     | 5        | 23       | 60       | 13        | 17.3    | HT-95/120AL    | 2             |
| FBL95CBB       | Bi Metal Flexi Ali Narrow palm Crimp lug, 95mm Blank  | 95                                    |                | 105    | 20     | 5        | 23       | 60       |           | 17.3    | HT-95/120AL    | 2             |
| FBL120CBM8     | Bi Metal Flexi Ali Narrow palm Crimp lug, 120mm M8    | 120                                   | 17.5           | 115    | 25     | 6        | 29       | 60       | 8.5       | 22      | HT-150/185AL   | 2             |
| FBL120CBM10    | Bi Metal Flexi Ali Narrow palm Crimp lug, 120mm M10   | 120                                   | 17.5           | 115    | 25     | 6        | 29       | 60       | 10.5      | 22      | HT-150/185AL   | 2             |
| FBL120CBM12    | Bi Metal Flexi Ali Narrow palm Crimp lug, 120mm M12   | 120                                   | 17.5           | 115    | 25     | 6        | 29       | 60       | 13        | 22      | HT-150/185AL   | 2             |
| FBL120CBB      | Bi Metal Flexi Ali Narrow palm Crimp lug, 120mm Blank | 120                                   |                | 115    | 25     | 6        | 29       | 60       |           | 22      | HT-150/185AL   | 2             |
| FBL150CBM8     | Bi Metal Flexi Ali Narrow palm Crimp lug, 150mm M8    | 150                                   | 18.7           | 115    | 25     | 6        | 29       | 60       | 8.5       | 22      | HT-150/185AL   | 2             |
| FBL150CBM10    | Bi Metal Flexi Ali Narrow palm Crimp lug, 150mm M10   | 150                                   | 18.7           | 115    | 25     | 6        | 29       | 60       | 10.5      | 22      | HT-150/185AL   | 2             |
| FBL150CBM12    | Bi Metal Flexi Ali Narrow palm Crimp lug, 150mm M12   | 150                                   | 18.7           | 115    | 25     | 6        | 29       | 60       | 13        | 22      | HT-150/185AL   | 2             |
| FBL150CBB      | Bi Metal Flexi Ali Narrow palm Crimp lug, 150mm Blank | 150                                   |                | 115    | 25     | 6        | 29       | 60       |           | 22      | HT-150/185AL   | 2             |
| FBL185CBM8     | Bi Metal Flexi Ali Narrow palm Crimp lug, 185mm M8    | 185                                   | 19.5           | 115    | 25     | 6        | 29       | 60       | 8.5       | 22      | HT-150/185AL   | 2             |
| FBL185CBM10    | Bi Metal Flexi Ali Narrow palm Crimp lug, 185mm M10   | 185                                   | 19.5           | 115    | 25     | 6        | 29       | 60       | 10.5      | 22      | HT-150/185AL   | 2             |
| FBL185CBM12    | Bi Metal Flexi Ali Narrow palm Crimp lug, 185mm M12   | 185                                   | 19.5           | 115    | 25     | 6        | 29       | 60       | 13        | 22      | HT-150/185AL   | 2             |
| FBL185CBB      | Bi Metal Flexi Ali Narrow palm Crimp lug, 185mm Blank | 185                                   |                | 115    | 25     | 6        | 29       | 60       |           | 22      | HT-150/185AL   | 2             |
| FBL240CBM8     | Bi Metal Flexi Ali Narrow palm Crimp lug, 240mm M8    | 240                                   | 24             | 122    | 30     | 8        | 35       | 60       | 8.5       | 28.4    | HT-240/300AL   | 2             |
| FBL240CBM10    | Bi Metal Flexi Ali Narrow palm Crimp lug, 240mm M10   | 240                                   | 24             | 122    | 30     | 8        | 35       | 60       | 10.5      | 28.4    | HT-240/300AL   | 2             |
| FBL240CBM12    | Bi Metal Flexi Ali Narrow palm Crimp lug, 240mm M12   | 240                                   | 24             | 122    | 30     | 8        | 35       | 60       | 13        | 28.4    | HT-240/300AL   | 2             |
| FBL240CBB      | Bi Metal Flexi Ali Narrow palm Crimp lug, 240mm Blank | 240                                   |                | 122    | 30     | 8        | 35       | 60       |           | 28.4    | HT-240/300AL   | 2             |
| FBL300CBM10    | Bi Metal Flexi Ali Narrow palm Crimp lug, 300mm M10   | 300                                   | 26.5           | 122    | 30     | 8        | 35       | 60       | 10.5      | 28.4    | HT-240/300AL   | 2             |
| FBL300CBM12    | Bi Metal Flexi Ali Narrow palm Crimp lug, 300mm M12   | 300                                   | 26.5           | 122    | 30     | 8        | 35       | 60       | 13        | 28.4    | HT-240/300AL   | 2             |
| FBL300CBM16    | Bi Metal Flexi Ali Narrow palm Crimp lug, 300mm M16   | 300                                   | 26.5           | 122    | 30     | 8        | 35       | 60       | 17        | 28.4    | HT-240/300AL   | 2             |
| FBL300CBB      | Bi Metal Flexi Ali Narrow palm Crimp lug, 300mm Blank | 300                                   |                | 122    | 30     | 8        | 35       | 60       |           | 28.4    | HT-240/300AL   | 2             |
| FBL400CBM10    | Bi Metal Flexi Ali Narrow palm Crimp lug, 400mm M10   | 400                                   | 30.3           | 155    | 35     | 10.5     | 50       | 70       | 10.5      | 39      | ECW-H3D4/500AL | 2             |
| FBL400CBM12    | Bi Metal Flexi Ali Narrow palm Crimp lug, 400mm M12   | 400                                   | 30.3           | 155    | 35     | 10.5     | 50       | 70       | 13        | 39      | ECW-H3D4/500AL | 2             |
| FBL400CBM16    | Bi Metal Flexi Ali Narrow palm Crimp lug, 400mm M16   | 400                                   | 30.3           | 155    | 35     | 10.5     | 50       | 70       | 17        | 39      | ECW-H3D4/500AL | 2             |
| FBL400CBB      | Bi Metal Flexi Ali Narrow palm Crimp lug, 400mm Blank | 400                                   |                | 155    | 35     | 10.5     | 50       | 70       |           | 39      | ECW-H3D4/500AL | 2             |
| FBL500CBM10    | Bi Metal Flexi Ali Narrow palm Crimp lug, 500mm M10   | 500                                   | 32.5           | 155    | 35     | 10.5     | 50       | 70       | 10.5      | 39      | ECW-H3D4/500AL | 2             |
| FBL500CBM12    | Bi Metal Flexi Ali Narrow palm Crimp lug, 500mm M12   | 500                                   | 32.5           | 155    | 35     | 10.5     | 50       | 70       | 13        | 39      | ECW-H3D4/500AL | 2             |
| FBL500CBM16    | Bi Metal Flexi Ali Narrow palm Crimp lug, 500mm M16   | 500                                   | 32.5           | 155    | 35     | 10.5     | 50       | 70       | 17        | 39      | ECW-H3D4/500AL | 2             |
| FBL500CBB      | Bi Metal Flexi Ali Narrow palm Crimp lug, 500mm Blank | 500                                   |                | 155    | 35     | 10.5     | 50       | 70       |           | 39      | ECW-H3D4/500AL | 2             |
| FBL630CBM10    | Bi Metal Flexi Ali Narrow palm Crimp lug, 630mm M10   | 630                                   | 38             | 175    | 37     | 13       | 65       | 70       | 10.5      | 43.2    | RHU520-800     | 2             |
| FBL630CBM12    | Bi Metal Flexi Ali Narrow palm Crimp lug, 630mm M12   | 630                                   | 38             | 175    | 37     | 13       | 65       | 70       | 13        | 43.2    | RHU520-800     | 2             |
| FBL630CBM16    | Bi Metal Flexi Ali Narrow palm Crimp lug, 630mm M16   | 630                                   | 38             | 175    | 37     | 13       | 65       | 70       | 17        | 43.2    | RHU520-800     | 2             |
| FBL630CBB      | Bi Metal Flexi Ali Narrow palm Crimp lug, 630mm Blank | 630                                   |                | 175    | 37     | 13       | 65       | 70       |           | 43.2    | RHU520-800     | 2             |

In support of CABAC policy of continuous product improvement CABAC reserve the right to change materials and specifications without notice. Drawings, where shown, may not be to scale. Dimensions are metric and size may be approximate. Where possible data sheets including MSDS are made available on CABAC website and apps. All products should be installed and used in accordance to manufacturer's instruction provided. Warning: products may be subject of registered designs and patents. Refer to CABAC website or apps for terms and conditions on warranty.

## BI-METAL REDUCING LINKS FOR FIRSTFLEX FLA SERIES ALUMINIUM CABLES

The CABAC range of bi-metallic crimp links are designed specifically for terminating fine stranded Firstflex FLA series flexible aluminium cables to copper tails. The aluminium barrel is sized to suit the larger overall diameters of flexible conductors, ensuring full strand containment and reliable crimp performance.

The link comprises a high-conductivity aluminium barrel friction welded to an electrolytic copper barrel, providing a strong, corrosion-resistant transition joint. The barrel is pre-filled with oxide-inhibiting compound to minimise oxidation and maintain low contact resistance.

Suitable for hexagonal compression crimping using the specified A/F dies.

Where multiple crimps are required, crimp from the palm end toward the cable entry.

Conforms to: AS/NZS 4325.1 and IEC 61238-1-1

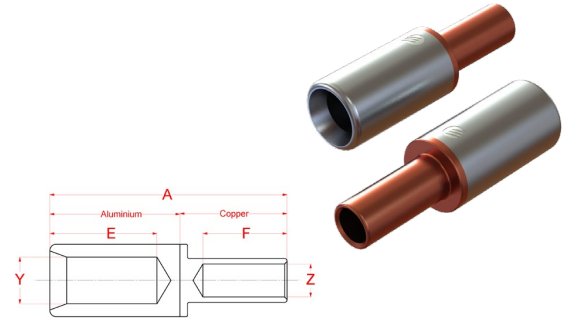

| Firstflex Code | CONDUCTOR CSA<br>mm <sup>2</sup> |     | A<br>(mm) | E<br>(mm) | F<br>(mm) | Y<br>(mm) | Z<br>(mm) | Aluminium Crimp Die |            |               | Copper Crimp Die |            |               |
|----------------|----------------------------------|-----|-----------|-----------|-----------|-----------|-----------|---------------------|------------|---------------|------------------|------------|---------------|
|                | AL                               | CU  |           |           |           |           |           | Die Part #          | AF<br>(mm) | No. of Crimps | Die Part #       | AF<br>(mm) | No. of Crimps |
| FBLK70/16      | 70                               | 16  | 70        | 32        | 24        | 12        | 5.5       | HT-50/70AL          | 13.2       | 1             | HT130-C-16       | 6.3        | 1             |
| FBLK70/25      | 70                               | 25  | 70        | 32        | 24        | 12        | 7.5       | HT-50/70AL          | 13.2       | 1             | HT130-C-25       | 7.7        | 1             |
| FBLK70/35      | 70                               | 35  | 70        | 32        | 24        | 12        | 8.5       | HT-50/70AL          | 13.2       | 1             | HT130-C-35       | 9.2        | 1             |
| FBLK70/50      | 70                               | 50  | 70        | 32        | 24        | 12        | 9.5       | HT-50/70AL          | 13.2       | 1             | HT130-C-50       | 10.4       | 1             |
| FBLK95/16      | 95                               | 16  | 110       | 60        | 32        | 14        | 5.5       | HT-95/120AL         | 17.3       | 2             | HT130-C-16       | 6.3        | 1             |
| FBLK95/25      | 95                               | 25  | 110       | 60        | 32        | 14        | 7.5       | HT-95/120AL         | 17.3       | 2             | HT130-C-25       | 7.7        | 1             |
| FBLK95/35      | 95                               | 35  | 110       | 60        | 32        | 14        | 8.5       | HT-95/120AL         | 17.3       | 2             | HT130-C-35       | 9.2        | 1             |
| FBLK95/50      | 95                               | 50  | 110       | 60        | 32        | 14        | 9.5       | HT-95/120AL         | 17.3       | 2             | HT130-C-50       | 10.4       | 1             |
| FBLK95/70      | 95                               | 70  | 110       | 60        | 32        | 14        | 11.5      | HT-95/120AL         | 17.3       | 2             | HT130-C-70       | 11.5       | 1             |
| FBLK120/16     | 120                              | 16  | 120       | 60        | 32        | 17.5      | 5.5       | HT-150/185AL        | 22.0       | 2             | HT130-C-16       | 6.3        | 1             |
| FBLK120/25     | 120                              | 25  | 120       | 60        | 32        | 17.5      | 7.5       | HT-150/185AL        | 22.0       | 2             | HT130-C-25       | 7.7        | 1             |
| FBLK120/35     | 120                              | 35  | 120       | 60        | 32        | 17.5      | 8.5       | HT-150/185AL        | 22.0       | 2             | HT130-C-35       | 9.2        | 1             |
| FBLK120/50     | 120                              | 50  | 120       | 60        | 32        | 17.5      | 9.5       | HT-150/185AL        | 22.0       | 2             | HT130-C-50       | 10.4       | 1             |
| FBLK120/70     | 120                              | 70  | 120       | 60        | 32        | 17.5      | 11.5      | HT-150/185AL        | 22.0       | 2             | HT130-C-70       | 11.5       | 1             |
| FBLK120/95     | 120                              | 95  | 120       | 60        | 32        | 17.5      | 13.5      | HT-150/185AL        | 22.0       | 2             | HT130-C-95       | 14.2       | 1             |
| FBLK150/16     | 150                              | 16  | 120       | 60        | 32        | 18.7      | 5.5       | HT-150/185AL        | 22.0       | 2             | HT130-C-16       | 6.3        | 1             |
| FBLK150/25     | 150                              | 25  | 120       | 60        | 32        | 18.7      | 7.5       | HT-150/185AL        | 22.0       | 2             | HT130-C-25       | 7.7        | 1             |
| FBLK150/35     | 150                              | 35  | 120       | 60        | 32        | 18.7      | 8.5       | HT-150/185AL        | 22.0       | 2             | HT130-C-35       | 9.2        | 1             |
| FBLK150/50     | 150                              | 50  | 120       | 60        | 32        | 18.7      | 9.5       | HT-150/185AL        | 22.0       | 2             | HT130-C-50       | 10.4       | 1             |
| FBLK150/70     | 150                              | 70  | 120       | 60        | 32        | 18.7      | 11.5      | HT-150/185AL        | 22.0       | 2             | HT130-C-70       | 11.5       | 1             |
| FBLK150/95     | 150                              | 95  | 120       | 60        | 32        | 18.7      | 13.5      | HT-150/185AL        | 22.0       | 2             | HT130-C-95       | 14.2       | 1             |
| FBLK150/120    | 150                              | 120 | 120       | 60        | 40        | 18.7      | 15.5      | HT-150/185AL        | 22.0       | 2             | HT130-C-120      | 16.5       | 2             |
| FBLK185/25     | 185                              | 25  | 120       | 60        | 32        | 19.5      | 7.5       | HT-150/185AL        | 22.0       | 2             | HT130-C-25       | 7.7        | 1             |
| FBLK185/35     | 185                              | 35  | 120       | 60        | 32        | 19.5      | 8.5       | HT-150/185AL        | 22.0       | 2             | HT130-C-35       | 9.2        | 1             |
| FBLK185/50     | 185                              | 50  | 120       | 60        | 32        | 19.5      | 9.5       | HT-150/185AL        | 22.0       | 2             | HT130-C-50       | 10.4       | 1             |
| FBLK185/70     | 185                              | 70  | 120       | 60        | 32        | 19.5      | 11.5      | HT-150/185AL        | 22.0       | 2             | HT130-C-70       | 11.5       | 1             |
| FBLK185/95     | 185                              | 95  | 120       | 60        | 40        | 19.5      | 13.5      | HT-150/185AL        | 22.0       | 2             | HT130-C-95       | 14.2       | 1             |
| FBLK185/120    | 185                              | 120 | 120       | 60        | 40        | 19.5      | 15.5      | HT-150/185AL        | 22.0       | 2             | HT130-C-120      | 16.5       | 2             |
| FBLK185/150    | 185                              | 150 | 120       | 60        | 40        | 19.5      | 16.5      | HT-150/185AL        | 22.0       | 2             | HT130-C-150      | 18.3       | 2             |
| FBLK240/25     | 240                              | 25  | 120       | 60        | 32        | 24        | 7.5       | HT-240/300AL        | 28.4       | 2             | HT130-C-25       | 7.7        | 1             |
| FBLK240/35     | 240                              | 35  | 120       | 60        | 32        | 24        | 8.5       | HT-240/300AL        | 28.4       | 2             | HT130-C-35       | 9.2        | 1             |
| FBLK240/50     | 240                              | 50  | 120       | 60        | 32        | 24        | 9.5       | HT-240/300AL        | 28.4       | 2             | HT130-C-50       | 10.4       | 1             |
| FBLK240/70     | 240                              | 70  | 120       | 60        | 32        | 24        | 11.5      | HT-240/300AL        | 28.4       | 2             | HT130-C-70       | 11.5       | 1             |
| FBLK240/95     | 240                              | 95  | 120       | 60        | 32        | 24        | 13.5      | HT-240/300AL        | 28.4       | 2             | HT130-C-95       | 14.2       | 1             |
| FBLK240/120    | 240                              | 120 | 120       | 60        | 40        | 24        | 15.5      | HT-240/300AL        | 28.4       | 2             | HT130-C-120      | 16.5       | 2             |
| FBLK240/150    | 240                              | 150 | 120       | 60        | 40        | 24        | 16.5      | HT-240/300AL        | 28.4       | 2             | HT130-C-150      | 18.3       | 2             |
| FBLK240/185    | 240                              | 185 | 120       | 60        | 40        | 24        | 18.5      | HT-240/300AL        | 28.4       | 2             | HT130-C-185      | 20.0       | 2             |

CONTINUED ON NEXT PAGE

In support of CABAC policy of continuous product improvement CABAC reserve the right to change materials and specifications without notice. Drawings, where shown, may not be to scale. Dimensions are metric and size may be approximate. Where possible data sheets including MSDS are made available on CABAC website and apps. All products should be installed and used in accordance to manufacturer's instruction provided. Warning: products may be subject of registered designs and patents. Refer to CABAC website or apps for terms and conditions on warranty.

## BI-METAL REDUCING LINKS FOR FIRSTFLEX FLA SERIES ALUMINIUM CABLES

The CABAC range of bi-metallic crimp links are designed specifically for terminating fine stranded Firstflex FLA series flexible aluminium cables to copper tails. The aluminium barrel is sized to suit the larger overall diameters of flexible conductors, ensuring full strand containment and reliable crimp performance.

The link comprises a high-conductivity aluminium barrel friction welded to an electrolytic copper barrel, providing a strong, corrosion-resistant transition joint. The barrel is pre-filled with oxide-inhibiting compound to minimise oxidation and maintain low contact resistance.

Suitable for hexagonal compression crimping using the specified A/F dies.

Where multiple crimps are required, crimp from the palm end toward the cable entry.

Conforms to: AS/NZS 4325.1 and IEC 61238-1-1

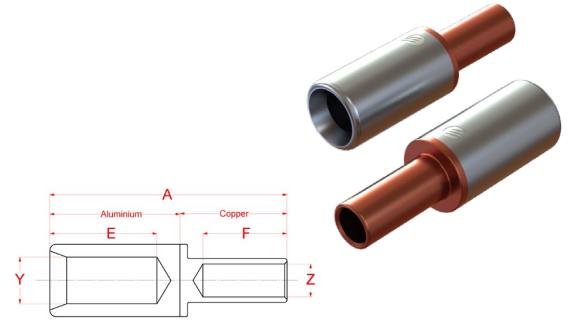

| Firstflex Code | CONDUCTOR CSA<br>mm <sup>2</sup> |     | A<br>(mm) | E<br>(mm) | F<br>(mm) | Y<br>(mm) | Z<br>(mm) | Aluminium Crimp Die |            |               | Copper Crimp Die |            |               |
|----------------|----------------------------------|-----|-----------|-----------|-----------|-----------|-----------|---------------------|------------|---------------|------------------|------------|---------------|
|                | AL                               | CU  |           |           |           |           |           | Die Part #          | AF<br>(mm) | No. of Crimps | Die Part #       | AF<br>(mm) | No. of Crimps |
| FBLK300/35     | 300                              | 35  | 120       | 60        | 32        | 26.5      | 8.5       | HT-240/300AL        | 28.4       | 2             | HT130-C-35       | 9.2        | 1             |
| FBLK300/50     | 300                              | 50  | 120       | 60        | 32        | 26.5      | 9.5       | HT-240/300AL        | 28.4       | 2             | HT130-C-50       | 10.4       | 1             |
| FBLK300/70     | 300                              | 70  | 120       | 60        | 32        | 26.5      | 11.5      | HT-240/300AL        | 28.4       | 2             | HT130-C-70       | 11.5       | 1             |
| FBLK300/95     | 300                              | 95  | 120       | 60        | 32        | 26.5      | 13.5      | HT-240/300AL        | 28.4       | 2             | HT130-C-95       | 14.2       | 1             |
| FBLK300/120    | 300                              | 120 | 120       | 60        | 40        | 26.5      | 15.5      | HT-240/300AL        | 28.4       | 2             | HT130-C-120      | 16.5       | 2             |
| FBLK300/150    | 300                              | 150 | 120       | 60        | 40        | 26.5      | 16.5      | HT-240/300AL        | 28.4       | 2             | HT130-C-150      | 18.3       | 2             |
| FBLK300/185    | 300                              | 185 | 120       | 60        | 40        | 26.5      | 18.5      | HT-240/300AL        | 28.4       | 2             | HT130-C-185      | 20.0       | 2             |
| FBLK300/240    | 300                              | 240 | 120       | 60        | 40        | 26.5      | 21.5      | HT-240/300AL        | 28.4       | 2             | HT130-C-240      | 23.1       | 3             |
| FBLK400/70     | 400                              | 70  | 155       | 70        | 40        | 30.3      | 11.5      | ECW-H3D4/500AL      | 39.0       | 2             | HT130-C-70       | 11.5       | 1             |
| FBLK400/95     | 400                              | 95  | 155       | 70        | 40        | 30.3      | 13.5      | ECW-H3D4/500AL      | 39.0       | 2             | HT130-C-95       | 14.2       | 1             |
| FBLK400/120    | 400                              | 120 | 155       | 70        | 56        | 30.3      | 15.5      | ECW-H3D4/500AL      | 39.0       | 2             | HT130-C-120      | 16.5       | 2             |
| FBLK400/150    | 400                              | 150 | 155       | 70        | 56        | 30.3      | 16.5      | ECW-H3D4/500AL      | 39.0       | 2             | HT130-C-150      | 18.3       | 2             |
| FBLK400/185    | 400                              | 185 | 155       | 70        | 56        | 30.3      | 18.5      | ECW-H3D4/500AL      | 39.0       | 2             | HT130-C-185      | 20.0       | 2             |
| FBLK400/240    | 400                              | 240 | 155       | 70        | 56        | 30.3      | 21.5      | ECW-H3D4/500AL      | 39.0       | 2             | HT130-C-240      | 23.1       | 3             |
| FBLK400/300    | 400                              | 300 | 155       | 70        | 56        | 30.3      | 23.5      | ECW-H3D4/500AL      | 39.0       | 2             | ECW-H3D-300      | 26.0       | 3             |
| FBLK500/95     | 500                              | 95  | 155       | 70        | 40        | 32.5      | 13.5      | ECW-H3D4/500AL      | 39.0       | 2             | HT130-C-95       | 14.2       | 1             |
| FBLK500/120    | 500                              | 120 | 155       | 70        | 40        | 32.5      | 15.5      | ECW-H3D4/500AL      | 39.0       | 2             | HT130-C-120      | 16.5       | 2             |
| FBLK500/150    | 500                              | 150 | 155       | 70        | 40        | 32.5      | 16.5      | ECW-H3D4/500AL      | 39.0       | 2             | HT130-C-150      | 18.3       | 2             |
| FBLK500/185    | 500                              | 185 | 155       | 70        | 56        | 32.5      | 18.5      | ECW-H3D4/500AL      | 39.0       | 2             | HT130-C-185      | 20.0       | 2             |
| FBLK500/240    | 500                              | 240 | 155       | 70        | 56        | 32.5      | 21.5      | ECW-H3D4/500AL      | 39.0       | 2             | HT130-C-240      | 23.1       | 3             |
| FBLK500/300    | 500                              | 300 | 155       | 70        | 56        | 32.5      | 23.5      | ECW-H3D4/500AL      | 39.0       | 2             | ECW-H3D-300      | 26.0       | 3             |
| FBLK500/400    | 500                              | 400 | 155       | 70        | 56        | 32.5      | 27.0      | ECW-H3D4/500AL      | 39.0       | 2             | ECW-H3D-400      | 28.1       | 3             |
| FBLK630/120    | 630                              | 120 | 155       | 70        | 56        | 38.0      | 15.5      | RHU520-800          | 43.2       | 2             | HT130-C-120      | 16.5       | 2             |
| FBLK630/150    | 630                              | 150 | 155       | 70        | 56        | 38.0      | 16.5      | RHU520-800          | 43.2       | 2             | HT130-C-150      | 18.3       | 2             |
| FBLK630/185    | 630                              | 185 | 155       | 70        | 56        | 38.0      | 18.5      | RHU520-800          | 43.2       | 2             | HT130-C-185      | 20.0       | 2             |
| FBLK630/240    | 630                              | 240 | 155       | 70        | 56        | 38.0      | 21.5      | RHU520-800          | 43.2       | 2             | HT130-C-240      | 23.1       | 3             |
| FBLK630/300    | 630                              | 300 | 155       | 70        | 56        | 38.0      | 23.5      | RHU520-800          | 43.2       | 2             | ECW-H3D-300      | 26.0       | 3             |
| FBLK630/400    | 630                              | 400 | 155       | 70        | 56        | 38.0      | 27.0      | RHU520-800          | 43.2       | 2             | ECW-H3D-400      | 28.1       | 3             |
| FBLK630/500    | 630                              | 500 | 155       | 70        | 56        | 38.0      | 30.0      | RHU520-800          | 43.2       | 2             | ECW-H3D-500      | 31.0       | 3             |

In support of CABAC policy of continuous product improvement CABAC reserve the right to change materials and specifications without notice. Drawings, where shown, may not be to scale. Dimensions are metric and size may be approximate. Where possible data sheets including MSDS are made available on CABAC website and apps. All products should be installed and used in accordance to manufacturer's instruction provided. Warning: products may be subject of registered designs and patents. Refer to CABAC website or apps for terms and conditions on warranty.